

COS GUNOI

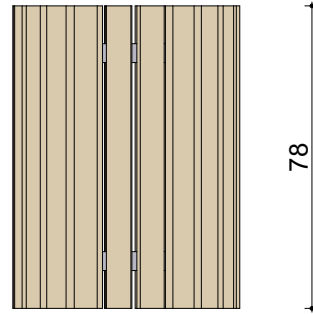

- Dimensiuni:
- inaltime cos: 78 cm;
 - diametru cos: 43,5 cm;
 - diametru cuva: 33 cm;
 - inaltime cuva: 50 cm;
 - capacitate cuva: 42,7 L;
 - Materiale: metal galvanizat sau vopsit in camp electrostatic, gradene de lemn din rasinoase sau fag

CISMEA

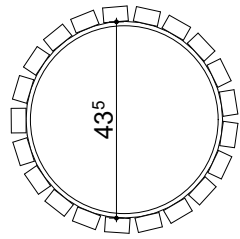
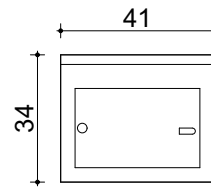

- Dimensiuni:
- lungime: 41 cm;
 - latime: 34 cm;
 - inaltime: 102 cm;
 - Materiale: inox

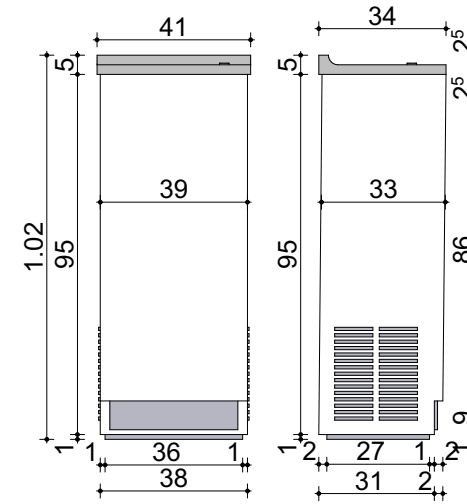

BANCA

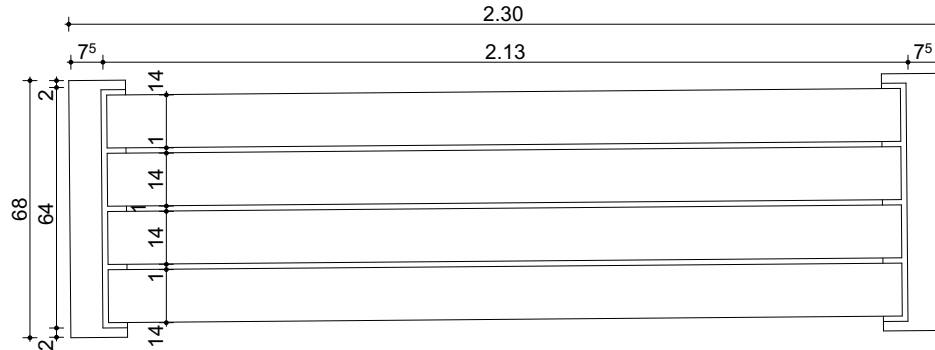

- Dimensiuni:
- lungime: 230 cm;
 - latime: 70 cm;
 - inaltime: 40 cm;
- Materiale: lemn tropical, granit

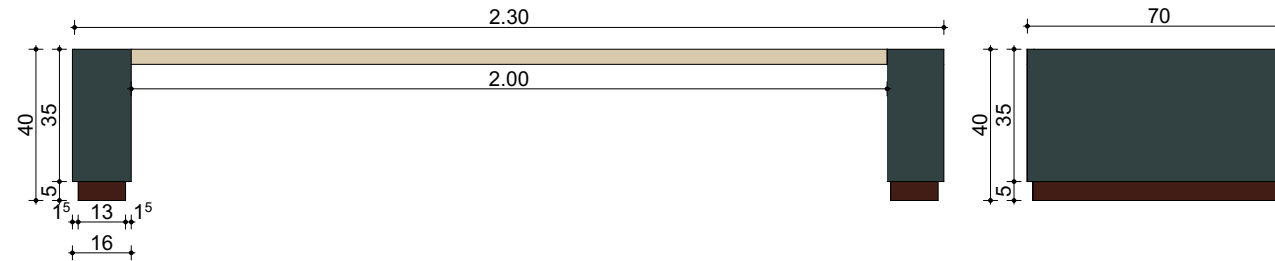

MASA

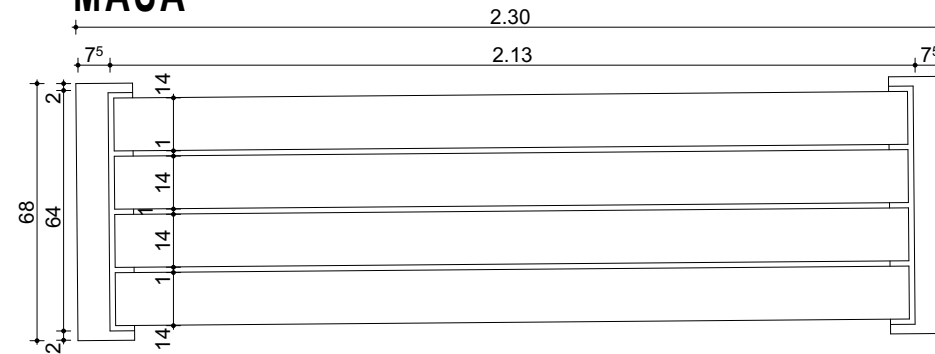

- Dimensiuni:
- lungime: 230 cm;
 - latime: 70 cm;
 - inaltime: 70 cm;
- Materiale: lemn tropical, granit

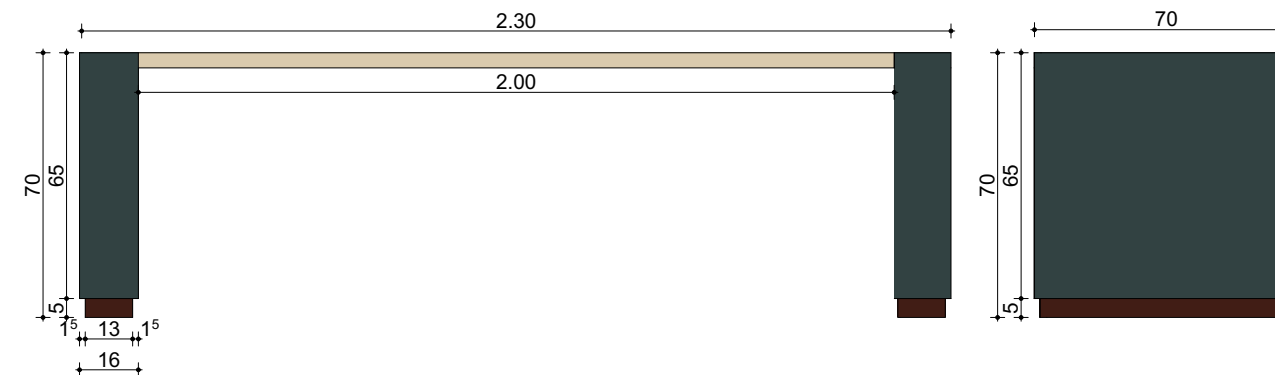

DENUMIRE PROIECT:
Amenajare imprejmuire si amenajare curte (alei, asfaltare teren de sport) la Liceul Tehnologic Nr.1

ADRESA PROIECT:
Sos Turnu Măgurele, Nr. 1-3 mun. Alexandria jud. Teleorman Romania

CLASA DE IMPORTANȚĂ - CLASA IMP.C
CATEGORIA DE IMPORTANȚĂ - CATEG. IMP.III
GRAD DE REZISTENȚĂ LA FOC - II
ARIE CONSTRUITĂ LA SOL = 3985 mp
ARIE CONSTRUITA DESFASURATA = 5776 mp

BENEFICIAR:
Pimaria Municipului Alexandria

PROIECTANT GENERAL:
S.C. ATKA CONSTRUCT SRL



PROIECTANT SPECIALITATE:
S.C. ATKA CONSTRUCT SRL



SEF PROIECT:
Arh. Ghebrî Vlad

ARHITECTURA:
Arh. Elisabeta Vlase

DESEMAT:
Arh. Ghebrî Vlad

PROIECTANT STRUCTURA:
Ing. Platka Gavril

VERIFICATOR:
Ing. Popa Oliviu

D.A.L.I.
MOBILIER EXTERIOR

Proiect nr.:
12/2023

Scara:
1:20

Dim. plansa:
420x297

Plansa:
13 din 39

Data:
07/2023

Faza | Plansa | Revizia
DALI A-10 - 00